

ALL NEW - OKKI NOKKI ONE - REINVENTED  
 RECORD CLEANING MACHINE  
**OKKI NOKKI**

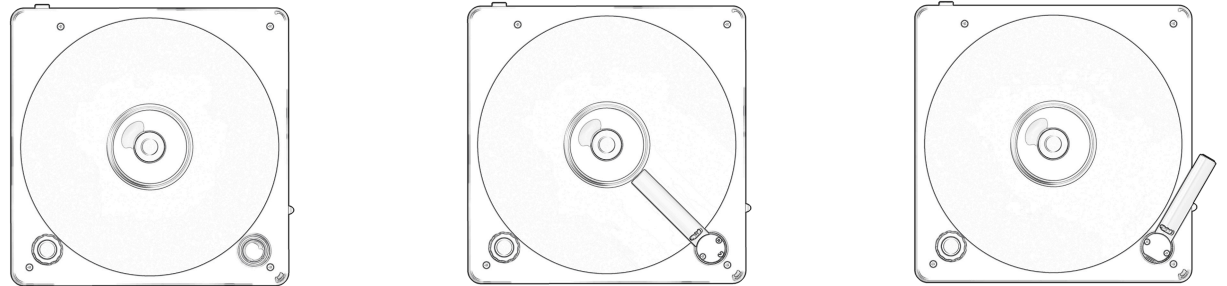

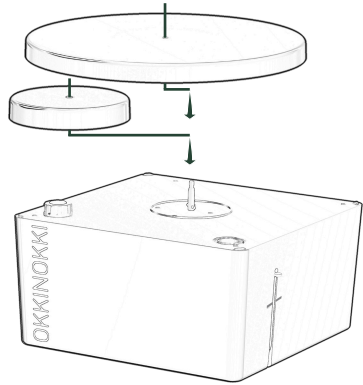
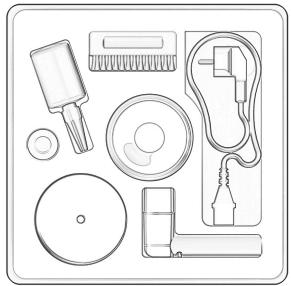
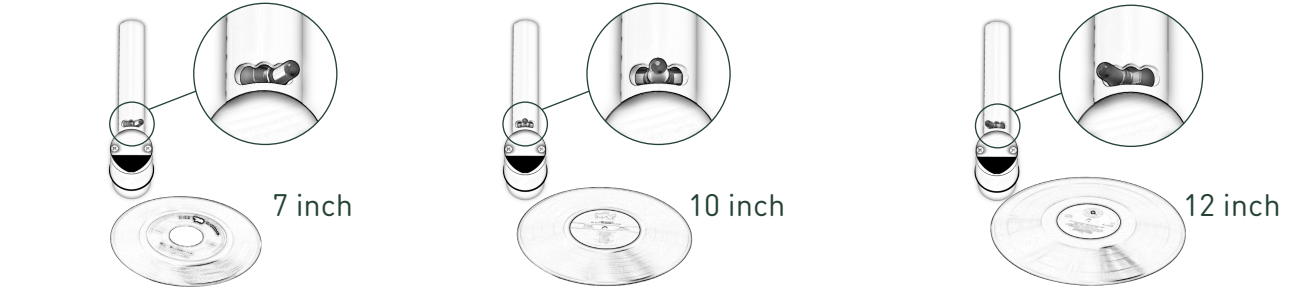
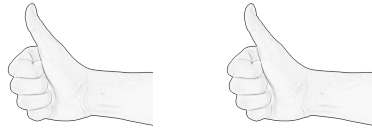
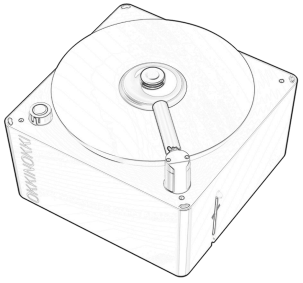
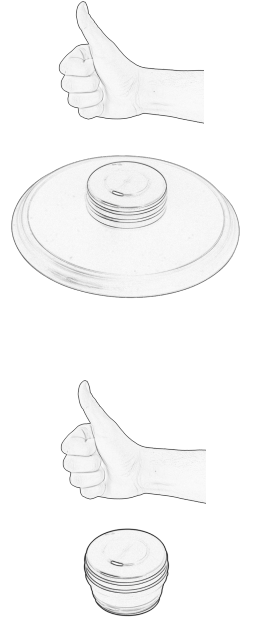
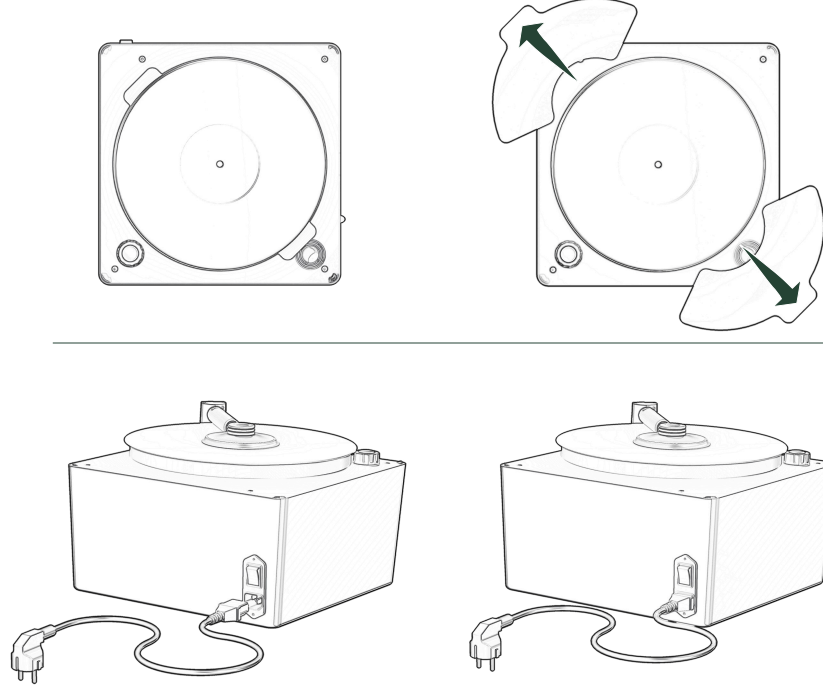
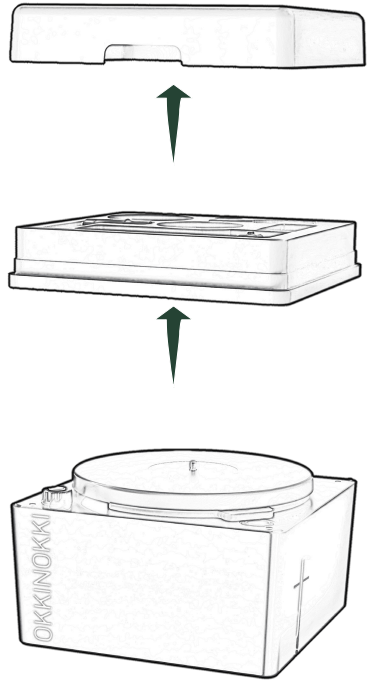
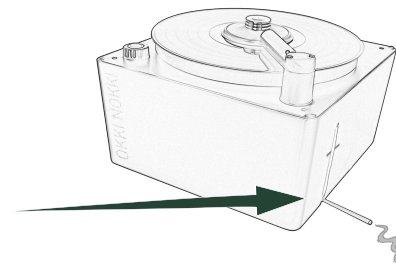
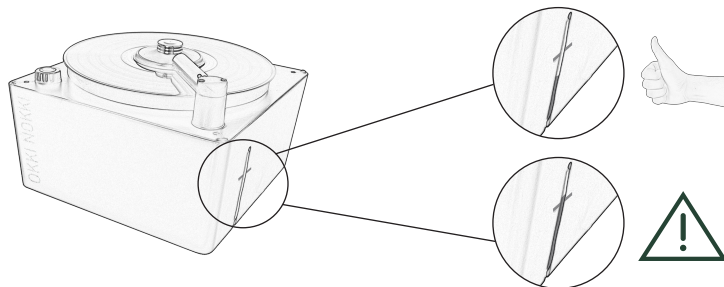
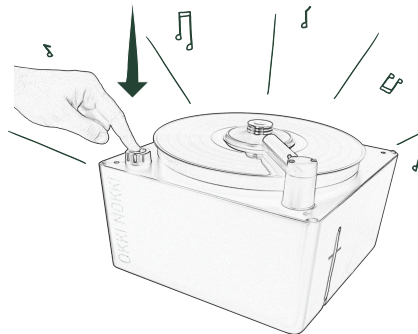
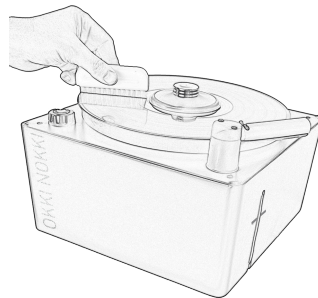
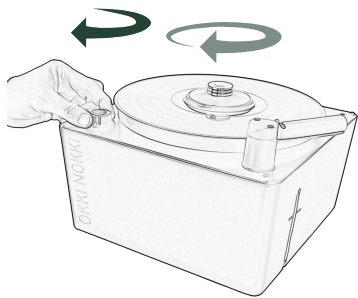
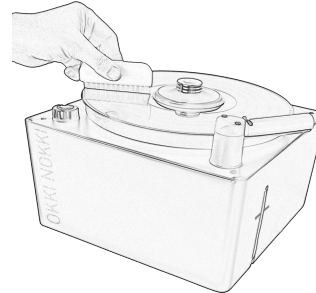
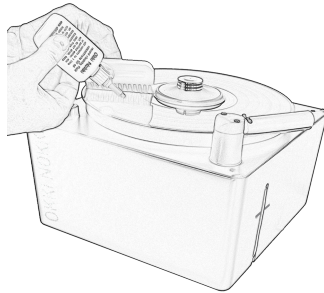
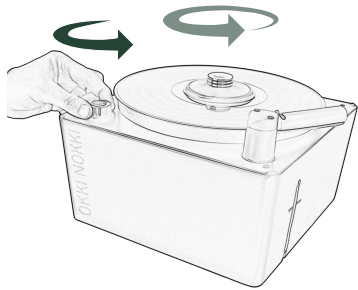
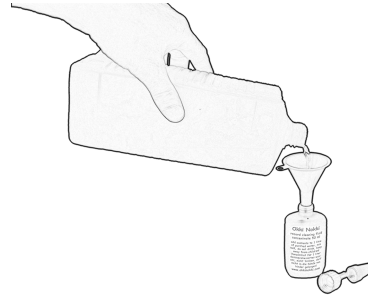

SCAN ME

## ALL NEW - OKKI NOKKI ONE - REINVENTED RECORD CLEANING MACHINE OKKI NOKKI

### Warning and Safety instructions

This machine complies with current safety requirements. Improper use can, however, present a risk of both personal injury and material damage. To avoid the risk of accidents and damage to the machine, please read these instructions carefully before using it for the first time. They contain important notes on setting it up, as well as on its safety, operation and maintenance. Okki Nokki cannot be held liable for damage caused by non-compliance with these Warning and Safety instructions. Keep the instructions in a safe place and pass them on to any future owner.

#### Correct application

This machine is intended for use in domestic households and similar working and residential environment. This machine is not intended for outdoor use. Any other use is not permitted.

This machine can only be used by people with reduced physical, sensory or mental capabilities, or lack of experience and knowledge, if they are supervised whilst using it, or have been shown how to use it in a safe way and recognize and understand the consequences of incorrect operation.

Install the machine where it is out of the reach of children. Children under eight years of age must be kept away from the machine and the mains connection cable and plug/socket. Children 8 years and older may only use the machine unsupervised if they have been shown how to use it safely and recognize and understand the consequences of incorrect operation. Please supervise children in the vicinity of the machine and do not allow them to play with it.

#### Technical safety

A damaged machine is dangerous. Check it for any visible damage before setting it up. Never attempt to use a damaged machine.

To avoid the risk of damage to the machine, make sure the connection data (voltage and frequency) on the data plate corresponds to the household supply, before connecting the machine to the mains supply. Consult a qualified electrician if in any doubt.

The electrical safety of this machine can only be guaranteed when correctly earthed. It is essential that this standard safety requirement is met. If in any doubt please have the electrical installation tested by a qualified electrician.

Reliable and safe operation of the machine can only be guaranteed if it is connected to the mains electrical supply.

Do not connect the machine to the mains electricity supply by a multi-socket adapter or an extension lead. These are a fire hazard and do not guarantee the required safety of the appliance.

The machine must not be used in a non-stationary location (e.g. on a ship).

Unplug the machine from the power supply immediately if you notice any damage or smell scorching, for example.

Ensure that the mains connection cable cannot be pinched or damaged by any sharp edges.

The mains connection cable should not hang down. Someone could trip over it with the risk of injury and damage the machine.

## Okki Nokki accessories

For Okki Nokki fluid and accessories go to your dealer or the Okki Nokki website [www.okkinokki.com](http://www.okkinokki.com)

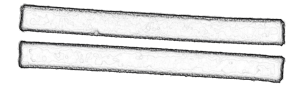

Okki Nokki velvet replacement strips

## Only use Okki Nokki record cleaning fluid



#### Danger of overheating!

Ensure that there is sufficient ventilation around the machine. Protect the machine from water and water spray. Do not immerse the machine in water.

Repairs and other work by unqualified persons to the machine and the connection cable could be dangerous. The manufacturer cannot be held liable for unauthorized work. Repairs may only be carried out by an Okki Nokki authorized service technician.

While the machine is under guarantee, repairs should only be undertaken by an Okki Nokki authorized service technician. Otherwise, the guarantee is invalidated.

The manufacturer can only guarantee the safety of the machine when Okki Nokki replacement parts are used. Faulty components must only be replaced by genuine Okki Nokki Original spare parts.

The machine must be disconnected from the electricity supply during repair work.

The device is only voltage-free if the plug has been pulled out of the socket.

Pull the plug and not the connecting cable. Never open the outer casing of the machine.

Tampering with electrical connections or components and mechanical parts is highly dangerous to the user and can cause operational faults or electric shock.

Disconnect the machine from the power supply if it is not going to be used for a while.

Only use genuine original Okki Nokki accessories with this machine.

Using spare parts or accessories from other manufacturers will invalidate the guarantee, and Okki Nokki cannot accept liability.

Disposal of your old appliance Electrical and electronic appliances often contain valuable materials. They also contain materials which, if handled or disposed of incorrectly, could be potentially hazardous to human health and to the environment. They are, however, essential for the correct functioning of your appliance. Please do not therefore dispose of it with your household waste. Please dispose of it at your local community waste collection / recycling center or contact your Dealer for advice. Ensure that it presents no danger to children while being stored for disposal.

